

**NEW for 2023!**



# UP COUNTRY



by **TLRV**

## A new twist on an old favorite.

Starting with our two most popular floorplans, we have taken what great about them and made them even better. Our all-new laminated construction provides more structural strength while decreasing weight. A standard North/South bed means you don't have to sacrifice comfort to go Up Country.

North-South Bed Standard • Laminated Structure • 200W Solar Standard  
Redesigned Bed area cabinetry • On-Demand Water Heater

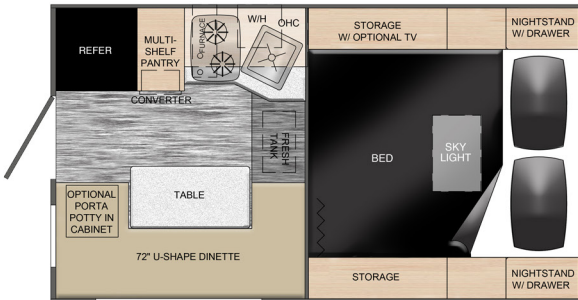

### Up Country 650

Dry Weight	1250lbs	Ext. Height (no A/C)	87"
Ext. Length	164"	Ext. Height (w/ A/C)	99"
Ext. Width	87"	Int. Height	80"
Ext. Floor Length	74.5"	C.O.G. (From Front)	26.5"
Ext. Floor Width	45.5"	Cabover Bed	74"x60"
Table	18"x35"	Fresh Water	13 gal.

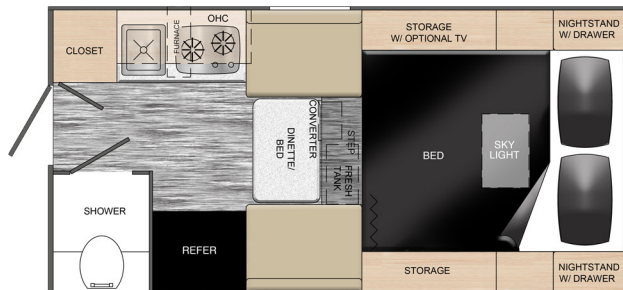

### Up Country 775

Dry Weight	1450lbs	Ext. Height (no A/C)	87"
Ext. Length	176"	Ext. Height (w/ A/C)	99"
Ext. Width	87"	Int. Height	80"
Ext. Floor Length	93.5"	C.O.G. (From Front)	35"
Ext. Floor Width	45.5"	Cabover Bed	74"x60"
Table	18"x35"	Fresh Water	13 gal.