

TLRV

Go Anywhere
with Any Thing!



Adventure made affordable!

One of the most affordable travel trailers on the market and light enough to pull behind even the smallest of vehicles - with no compromise to quality.

Ask about our
New Hydro-Lite technology
sidewalls and one piece roof!



Contact a dealer near you...

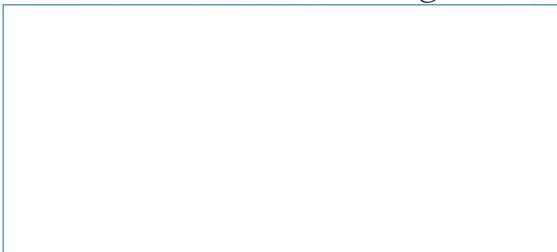

Protected by
Tuson Sway Control



Tuson RV Brakes, LLC
US PAT. NO. 9,026,311 / 9,415,753 AUS PAT. NO. 2014200434 / 2014204948

ROVE LITE

TLRV



Get off the Road!

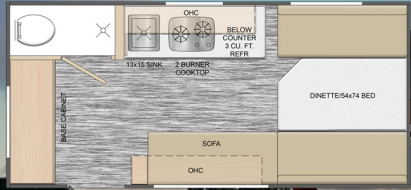

14FD

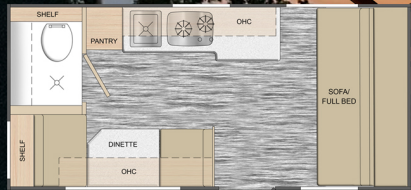

14FL

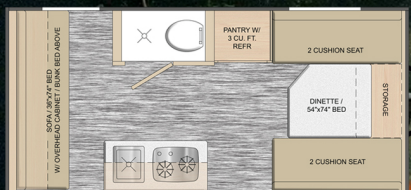

14BH

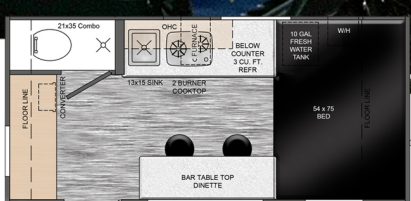

14FS

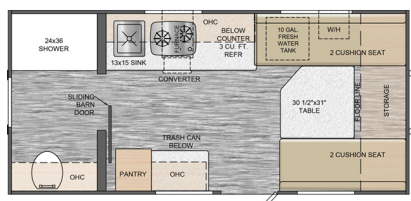

14FB

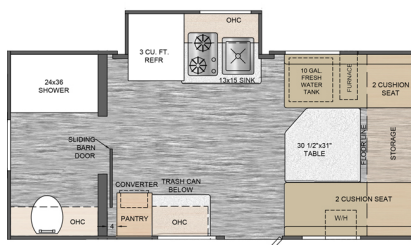

14FBS

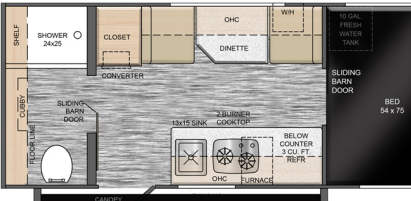

16RB

| | 14FD | 14FL | 14BH | 14FS | 14FB | 14FBS | 16RB |
|-----------------------|---------|---------|---------|---------|---------|---------|---------|
| Hitch Weight | 188 | 220 | 184 | 136 | 248 | 288 | 154 |
| Hitch Height | 17" | 17" | 17" | 17" | 17" | 17" | 17" |
| Hitch Height w/ORP | 23" | 23" | 23" | 23" | 23" | 23" | n/a |
| UVW (average in lbs) | 1702 | 1846 | 1748 | 2044 | 2020 | 2202 | 2020 |
| CCC (lbs) | 798 | 654 | 752 | 456 | 480 | 1298 | 1480 |
| GVWR (lbs) | 2500 | 2500 | 2500 | 2500 | 2500 | 3500 | 3500 |
| Exterior Length | 16'6" | 16'6" | 16'6" | 16'6" | 17'6" | 17'6" | 18'9" |
| Exterior Height | 8'1" | 8'1" | 8'1" | 8'1" | 8'1" | 8'1" | 8'1" |
| Exterior Height w/ORP | 9' | 9' | 9' | 9' | 9' | 9' | 9' |
| Exterior Width | 7'11" | 7'11" | 7'11" | 7'11" | 7'11" | 7'11" | 7'11" |
| Fresh Water | 10 gal | 10 gal | 10 gal | 10 gal | 10 gal | 10 gal | 10 gal |
| Gray Water | 30 gal | 30 gal | 30 gal | 30 gal | 30 gal | 30 gal | 30 gal |
| Black Water | 15 gal | 15 gal | 15 gal | 15 gal | 15 gal | 15 gal | 30 gal |
| Awning Size | 9' | 9' | 9' | 9' | 9' | 9' | 9' |
| Main Bed Size | 54"x74" | 50"x74" | 54"x74" | 54"x74" | n/a | n/a | 48"x75" |
| Dinette Bed Size | n/a | 24"x74" | n/a | n/a | 54"x74" | 54"x74" | n/a |
| Upper Bunk Size | n/a | n/a | 32"x74" | n/a | n/a | n/a | n/a |
| Lower Bunk Size | n/a | n/a | 36"x74" | n/a | n/a | n/a | n/a |
| Bunk Capacity | n/a | n/a | 150lbs | n/a | n/a | n/a | n/a |